

SUPREME DUTY HOSE REELS T SERIES

COXREELS® T Series "Truck Mount" spring driven hose reels are the toughest hose reels in the spring driven line. The extra large chassis with dual pedestal-style arms and Coxreels' Super Hub™ provides triple axle support while reducing vibration and strengthening the structural integrity of the reel. Making it perfect for off-road applications that demand reliability in the most abusive and demanding environments.

LOW PRESSURE

Models with hose are for air or water service with a maximum temperature 65° C. Models less hose can be used for air, water or oil.
Note: Do not exceed listed hose O.D. to obtain maximum length.

HOSE							LESS HOSE		SIZE INDEX
MODEL	I.D. mm	O.D. mm	LENGTH m	BAR	Kg.	AVAILABLE IN EZ-COIL	MODEL	Kg.	
TSH-N-350	10	16	15	21	28	EZ-TSH-350	TSHL-N-350	25	1
TSH-N-375	10	16	23	21	37	EZ-TSH-375	TSHL-N-375	33	2
TSH-N-3100	10	16	30	21	39	EZ-TSH-3100	TSHL-N-3100	34	2
TSH-N-3125	10	16	38	21	47	-	TSHL-N-3125	41	2
TSH-N-450	13	19	15	21	29	EZ-TSH-450	TSHL-N-450	25	1
TSH-N-475	13	19	23	21	37	EZ-TSH-475	TSHL-N-475	32	2
TSH-N-4100	13	19	30	21	43	EZ-TSH-4100	TSHL-N-4100	36	2
TSH-N-535	19	17	11	21	35	EZ-TSH-535	TSHL-N-535	30	3
TSH-N-550	19	17	15	21	38	EZ-TSH-550	TSHL-N-550	32	3
TSH-N-575	19	17	23	21	42	-	TSHL-N-575	33	4
TSH-N-635	25	38	11	21	42	-	TSHL-N-635	32	5
TSH-N-650	25	38	15	21	44	-	TSHL-N-650	35	4

To order EZ-Coil® equipped models less hose, please add prefix "EZ-"

MEDIUM PRESSURE

Reels are furnished with standard one wire braid hose suitable for air, water or oil applications. Hose exceeds SAE R1 specifications. Maximum temperature 120° C. **Note: Do not exceed listed hose O.D. to obtain maximum length.**

HOSE							LESS HOSE		SIZE INDEX
MODEL	I.D. mm	O.D. mm	LENGTH m	BAR	Kg.	AVAILABLE IN EZ-COIL	MODEL	Kg.	
TMP-N-350	10	17	15	207	34	EZ-TMP-350	TMPL-N-350	28	1
TMP-N-375	10	17	23	207	45	EZ-TMP-375	TMPL-N-375	36	2
TMP-N-3100	10	17	30	207	48	-	TMPL-N-3100	37	2
TMP-N-450	13	21	15	172	35	EZ-TMP-450	TMPL-N-450	29	1
TMP-N-475	13	21	23	172	45	EZ-TMP-475	TMPL-N-475	36	2
TMP-N-4100	13	21	30	172	48	-	TMPL-N-4100	36	2
TMP-N-525	19	17	8	103	30	-	TMPL-N-525	26	6
TMP-N-535	19	17	11	103	40	-	TMPL-N-535	34	3
TMP-N-550	19	17	15	103	43	EZ-TMP-550	TMPL-N-550	34	3
TMP-N-575	19	17	23	103	45	-	TMPL-N-575	35	7
TMP-N-650	25	35	15	86	53	-	TMPL-N-650	37	7

To order EZ-Coil® equipped models less hose, please add prefix "EZ-"

HIGH PRESSURE

Reels are furnished standard with S.A.E. 100R16 #1 or #2 wire braid hose suitable for grease and hydraulic oil applications. Maximum temp. 120° C. **Note: Do not exceed listed hose O.D. to obtain maximum length.**

HOSE							LESS HOSE		SIZE INDEX
MODEL	I.D. mm	O.D. mm	LENGTH m	BAR	Kg.	AVAILABLE IN EZ-COIL	MODEL	Kg.	
THP-N-150	6	14	15	345	34	EZ-THP-150	THPL-N-150	28	1
THP-N-175	6	14	23	345	40	EZ-THP-175	THPL-N-175	32	2
THP-N-1100	6	14	30	345	47	EZ-THP-1100	THPL-N-1100	37	2
THP-N-350	10	17	15	276	35	EZ-THP-350	THPL-N-350	30	1
THP-N-375	10	17	23	276	44	EZ-THP-375	THPL-N-375	36	2

To order EZ-Coil® equipped models less hose, please add prefix "EZ-"

REEL DIMENSIONS

SIZE INDEX	W mm	H mm	L mm	X mm	Y mm	M mm	N mm
1	238	540	495	203	229	178	203
2	238	648	610	203	229	178	203
3	238	648	610	203	229	178	203
4	305	648	610	203	229	178	203
5	254	648	610	203	229	178	203
6	251	556	518	203	229	178	203
7	318	648	610	203	229	178	203

Overall Dimensions Base Mounting Pattern

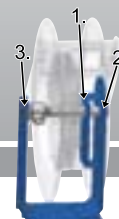
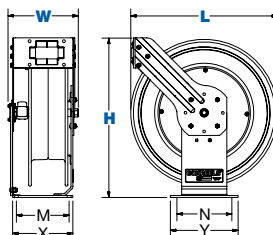

Triple axle support with a full frame & Super Hub™

T SERIES :: REEL SPECIFICATIONS

SWIVEL

- External fluid path with machined from solid brass 90° full-flow NPT swivel inlet (Zinc plated steel swivel on HP models)
- Swivel Seals: NITRILE
- Electroless nickel plated steel swivel on 25 mm models

DESIGN & STRUCTURE

- Sturdy dual pedestal reel features Coxreels' exclusive Super Hub™ dual axle support system
- Built for rugged mobile applications
- Guide arm adjusts to wall, floor, vehicle & overhead positions
- Stainless Steel rollers on 19 mm & 25 mm models
- Solid one piece, heavy gauge 6 mm steel base & support posts for maximum strength
- 25 mm solid steel axle & lubricated precision bearings for smooth rotation

RETRACTION

- Controlled retraction speed up to 80% slower on EZ-COIL models :: See page 7 for details
- Enclosed factory tuned & matched cartridge-style spring motor
- Non-corrosive stainless steel spring, pawl & zinc plated ratchet
- Multi-position lock ratchet mechanism secures hose at desired length

SIGNATURE FEATURES

- Professional grade heavy duty steel construction
- Durable proprietary CPC™ powder coat process
- Rolled edges & ribbed discs provide strength & safety
- Leading 2-year manufacturer's limited warranty
- Made in the U.S.A. - Sold & Supported Worldwide

POSSIBLE FIELDS OF APPLICATION

- Air/Water Services
- Pneumatic Tools
- Washdown
- Lubrication
- Fuel Delivery
- Chemical Fluid Transfer
- General Industrial
- Manufacturing Plants
- Lube Skids & Trucks
- Service / Mechanic / Utility Vehicles
- Mining, Construction & Railroad Operations
- Automotive, Fleet & Aircraft Maintenance

ACCESSORIZE YOUR REEL :: PG 50

- O-Rings & Swivels
- Mounting Brackets
- Hoses
- Assorted Reel Accessories

